

### To remove 1975 and later switches:

1. Disconnect the battery ground strap. Bleed all air pressure from the windshield washer fluid reservoir.
2. Carefully pry the horn button out of the center of the steering wheel.
3. Remove the nut that holds the steering wheel to the steering column. Then lift off the steering wheel.
4. Remove the spring and the spacer from the top end of the steering column.
5. Remove the four screws that hold the turn signal switch and the wiper switch to the lugs on the steering lock housing.

#### **NOTE** —

Be careful not to lose the four spacer tubes that are between the switches. The four switch mounting screws pass through the centers of these spacer tubes.

6. Disconnect the water hoses from the water valve on the wiper switch. Disconnect the wires for the turn signal switch and the wiper switch.
7. Remove the turn signal switch, the wiper switch, and the switch housing upper trim from the steering column.

8. Locate the round hole that is in the lower left-hand side of the lower part of the switch housing trim. The hole provides access to the shear bolt (Fig. 7-6).
9. Working through the access hole, drill into the center of the shear bolt. The hole that you drill should be at least 7 mm (or ¼ in.) deep.

#### **CAUTION** —

*To prevent the drill bit from wandering, which could damage the steering lock housing, carefully centerpunch the shear bolt before you attempt to drill it. Select a drill size that is appropriate to the diameter of the shear bolt and to the diameter of an available left-hand thread cutting tap.*

10. Insert a left-hand thread cutting tap into the drilled shear bolt. Then turn the tap counterclockwise in order to remove the shear bolt.
11. Insert the key into the ignition lock and unlock the steering column.

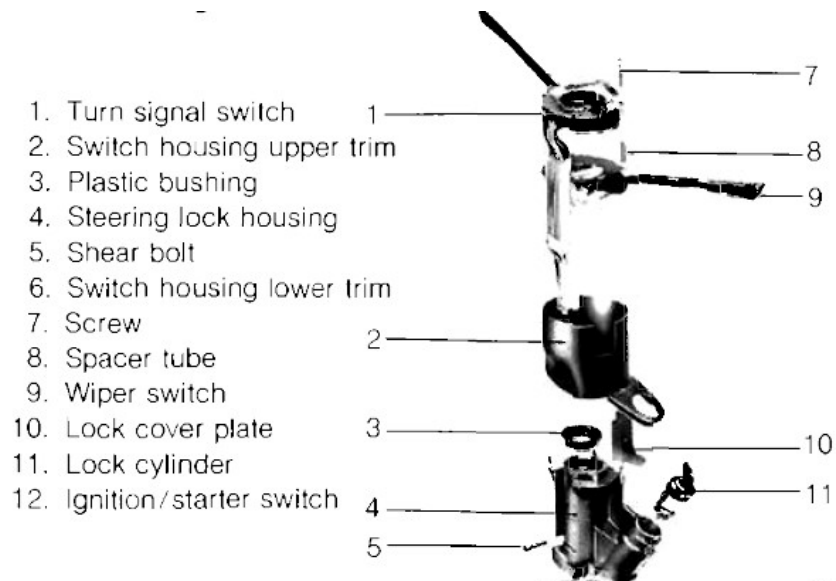

12. Working beneath the switch housing lower trim, remove the two Phillips head screws that hold the trim to the bottom of the steering lock housing.
13. Remove the steering lock by sliding it up and off the steering column.
14. If necessary, remove the ignition/starter switch mounting screw. Then remove the ignition/starter switch from the steering lock housing.
15. To remove the lock cylinder, use pliers to pull the lock cover plate out of the steering lock housing. This will provide access to the hole for lock cylinder removal.

You may find that on 1976 and later vehicles the hole used to release the retaining spring is missing. A hole must be drilled in the switch housing, as indicated in Fig. 7-7. Use a piece of steel wire inserted in the hole to depress the spring while you remove the cylinder.

**CAUTION**

Remove the turn signal and windshield wiper switches before you attempt to drill the hole. Use a drill with a 3-mm (or 1/8-in.) diameter.

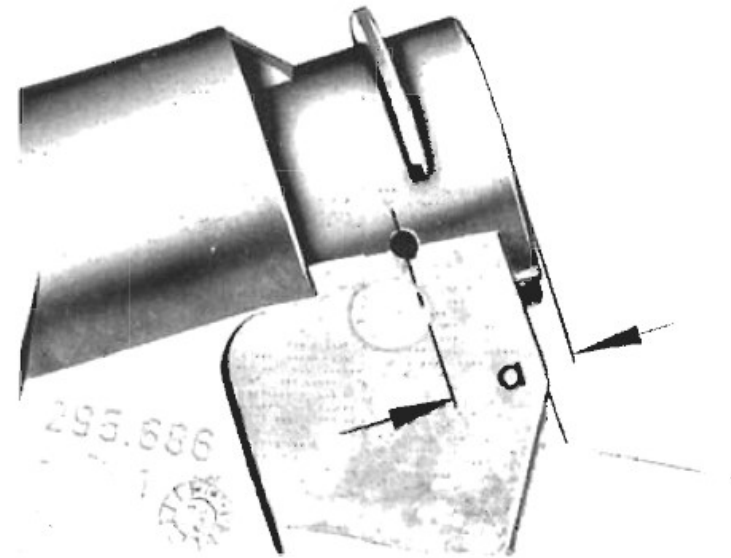

Fig. 7-7. Location for hole in ignition switch housing. Dimension **a** is 13 mm (just over 1/2 in.).

Installation is the reverse of removal. Loosely install a new shear bolt but do not tighten it until you have installed the steering wheel. Center the steering. Then install the steering wheel so that its spokes are horizontal. Torque the steering wheel nut to 5.0 mkg (36 ft. lb.).

With the steering wheel installed, adjust the gap between the bottom of the steering wheel and the face of the turn signal switch to 2 to 3 mm (1/16 to 1/8 in.). Then tighten the shear bolt until its head breaks off. Install the horn button so that the crest is upright when the steering wheel spokes are horizontal.