

ROCK 'N' ROLL BED

T2 SPLIT 1966-1967, T2 BAY 1967-1979, T25 1979-1992

JK part numbers: J14576

NOTE: This bed fits all rear engined VW Transporters from 1954 to 1992 and allows you to construct a bed of any width to suit your particular interior.



The kit consists of two main parts. The first part includes the seat and back rest.

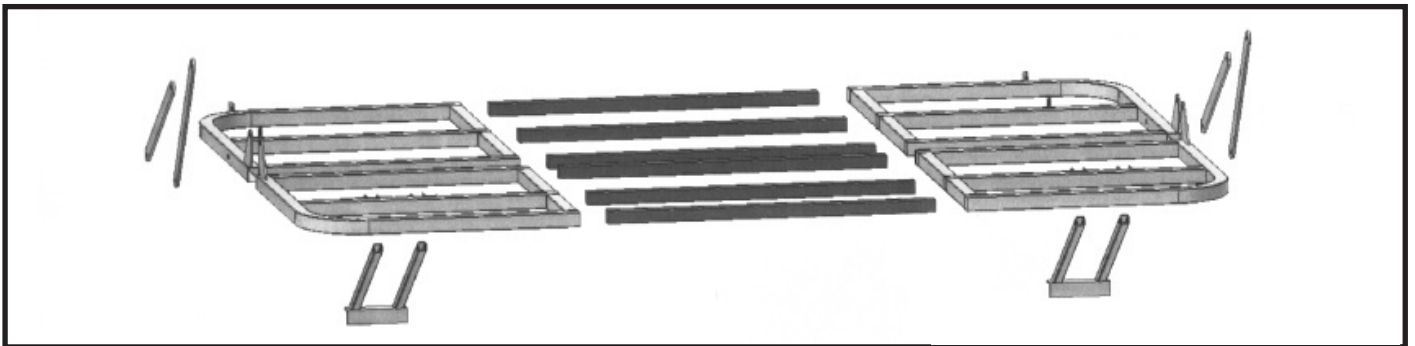

And the second part is the seat base. The central bars (shown above and below in dark grey) need to be shortened to a width of your choosing, alternatively you can leave them at their current length, if you wish to make a full width bed.

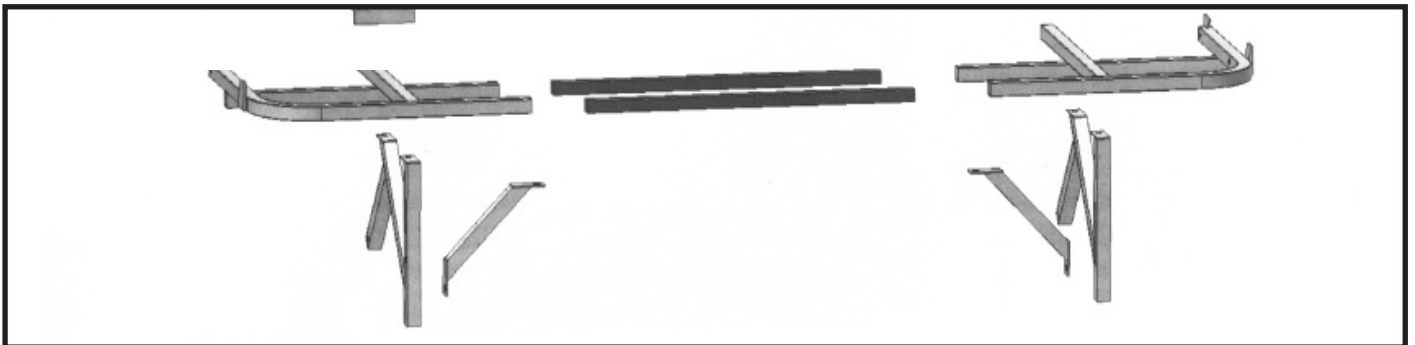

N.B. Whilst every attempt is made to ensure that these instructions are as accurate and clear as possible, we cannot be held responsible for misinterpretation of these instructions or for any subsequent accident or damage caused through mis-fitted parts.

ROCK 'N' ROLL BED

T2 SPLIT 1966-1967, T2 BAY 1967-1979, T25 1979-1992

JK part numbers: J14576

FITTING GUIDE

1. The first job is to decide on the width of your bed. Piece together parts (a), (b), (c) and (d) below and offer them up to your van. Once you have decided on the width of your bed, mark the central bars (b) and (c) and cut them down to the required length. When this is complete you can then make up the seat base. This consists of the parts layed out below.

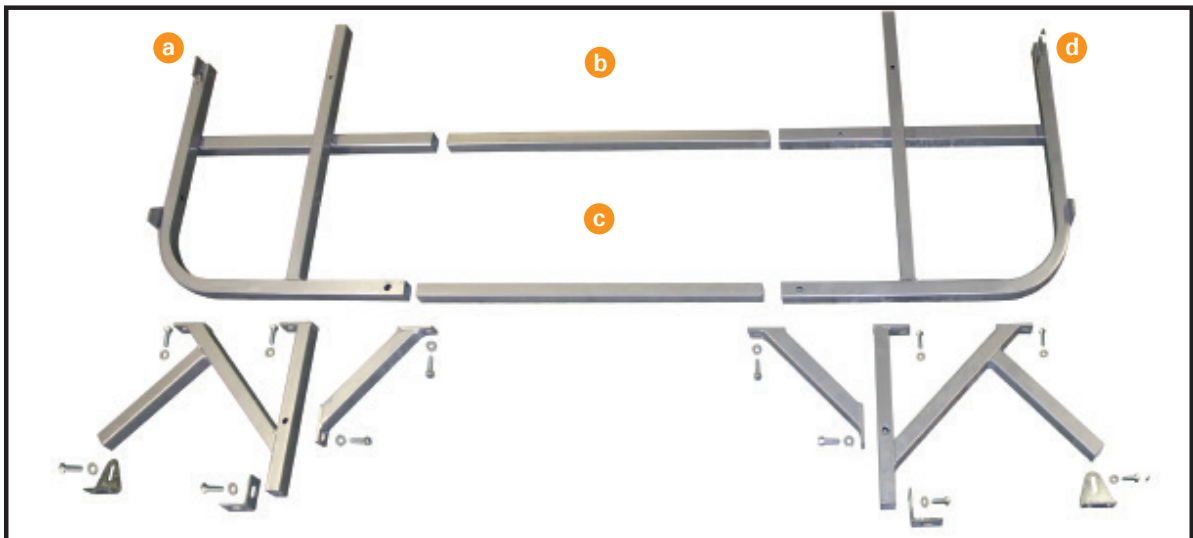

2. Using the bolts and washers supplied, bolt the above items together and then add the floor mounting brackets as shown below.

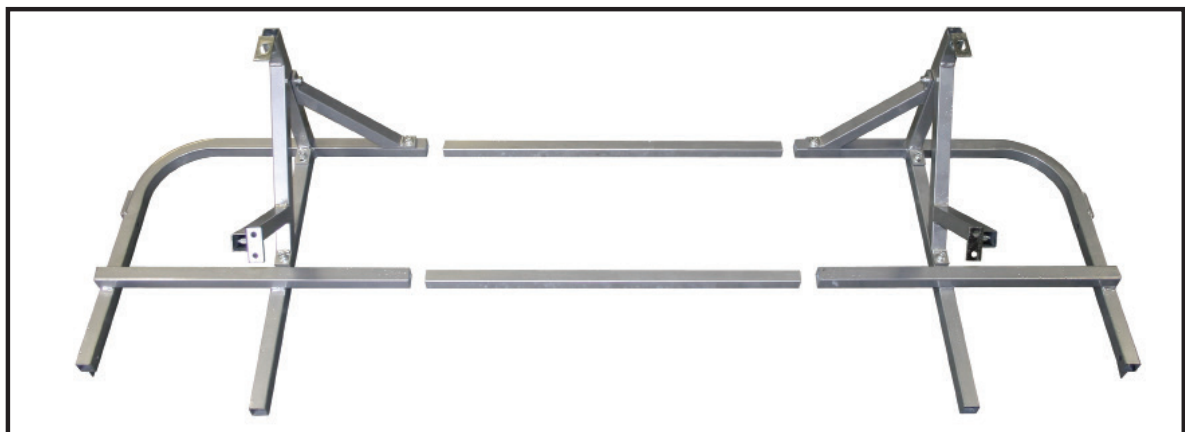

N.B. Whilst every attempt is made to ensure that these instructions are as accurate and clear as possible, we cannot be held responsible for misinterpretation of these instructions or for any subsequent accident or damage caused through mis-fitted parts.

ROCK 'N' ROLL BED

T2 SPLIT 1966-1967, T2 BAY 1967-1979, T25 1979-1992

JK part numbers: J14576

3. Below are the parts for the seat and back rest.



Washers must be placed between all the brackets to insure smooth operation.

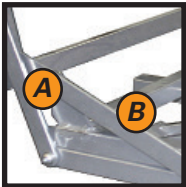

Note: Rod (A) has holes 1mm further apart than rod (B).



Strengthening brackets must be fitted with welds on top.

4. When bolted together, you should have something resembling this.

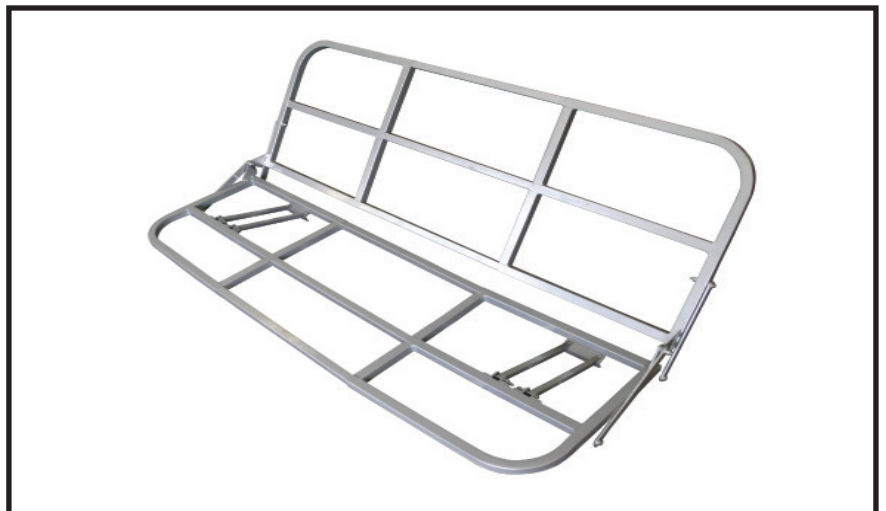

N.B. Whilst every attempt is made to ensure that these instructions are as accurate and clear as possible, we cannot be held responsible for misinterpretation of these instructions or for any subsequent accident or damage caused through mis-fitted parts.

ROCK 'N' ROLL BED

T2 SPLIT 1966-1967, T2 BAY 1967-1979, T25 1979-1992

JK part numbers: J14576

5. The top and base of the seat can now be joined together. This is done by sliding the seat frame over the triangular bracket on the seat base (see below). Once this is done the whole rock and roll bed can then be installed into the van.

The seat simply slides over the triangular bracket on the seat

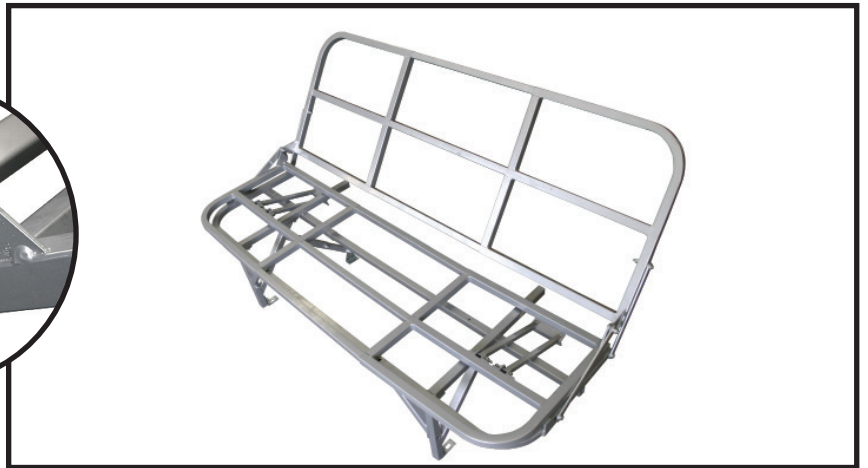
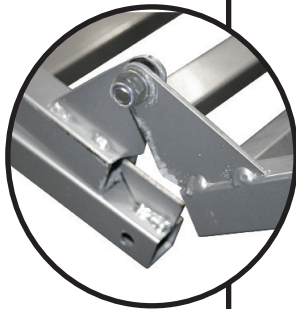

6. Place the frame in the van, making sure that it is level. Using the feet as guides, drill holes through the floor and rear bulkhead, then bolt the whole unit to the floor.

Caution: Don't forget that there is a fuel tank behind this bulkhead, so take care when drilling to avoid damaging the tank, wiring or any other hidden items.

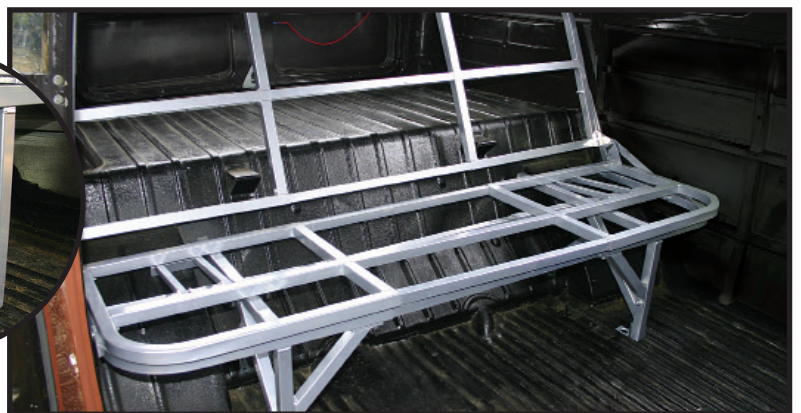

Note: Floor mounting bolts not included

N.B. Whilst every attempt is made to ensure that these instructions are as accurate and clear as possible, we cannot be held responsible for misinterpretation of these instructions or for any subsequent accident or damage caused through mis-fitted parts.

ROCK 'N' ROLL BED

T2 SPLIT 1966-1967, T2 BAY 1967-1979, T25 1979-1992

JK part numbers: J14576

7. Pull the seat into the bed position to check that it operates smoothly.

When in the bed position, these brackets are used to strengthen the end of the bed.



8. This Westfalia van already comes with steel brackets to support the centre of the bed. If your van doesn't have these, a wooden batten bolted to this bulkhead will be a worthwhile addition.

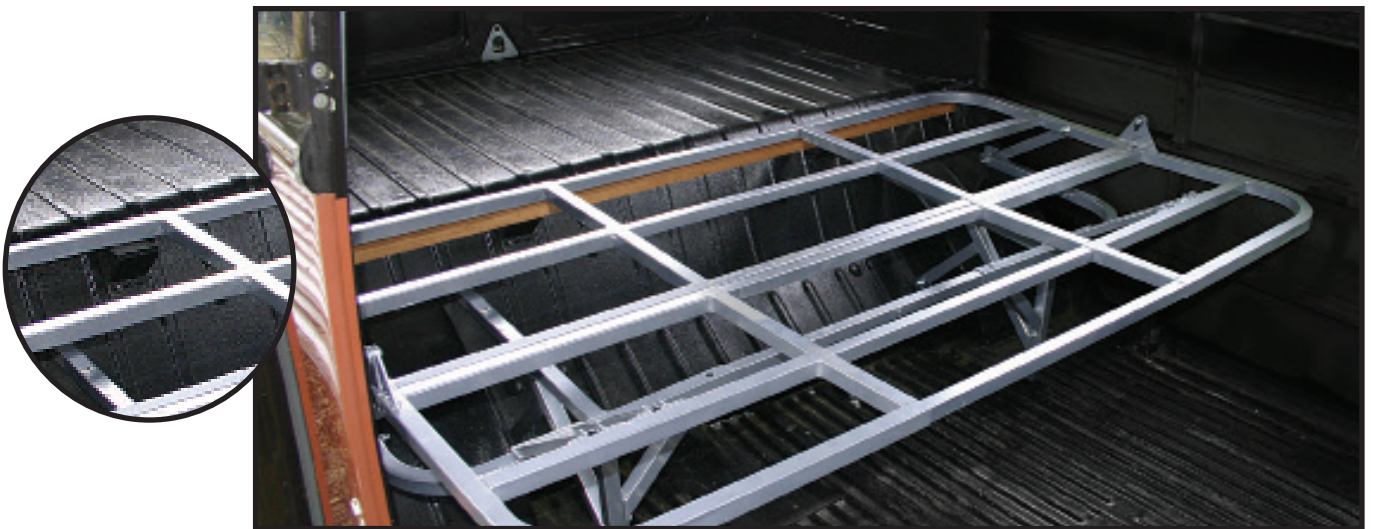

N.B. Whilst every attempt is made to ensure that these instructions are as accurate and clear as possible, we cannot be held responsible for misinterpretation of these instructions or for any subsequent accident or damage caused through mis-fitted parts.

ROCK 'N' ROLL BED

T2 SPLIT 1966-1967, T2 BAY 1967-1979, T25 1979-1992

JK part numbers: J14576

9. Cut a thin sheet of wood or MDF to the correct shape and screw it over the frame, followed by foam and your choice of fabric. The base of the seat could also be 'boxed in' with wood or MDF making a useful storage area under the seat

Caution: If you are fitting rear seatbelts, make sure that both the seat foam and fabric are securely fitted to the frame, otherwise the occupants can slide under their seatbelts causing possible injury.

(Poppers are ideal as they are strong and still allow the seat fabric to be removed for washing).



N.B. Whilst every attempt is made to ensure that these instructions are as accurate and clear as possible, we cannot be held responsible for misinterpretation of these instructions or for any subsequent accident or damage caused through mis-fitted parts.